

Meeting & Event Rentals



FROST
SCIENCE



We have events down to a science!

TABLE OF CONTENTS

- 4 Introduction
- 6 Museum Buyout
- 8 Aquarium Buyout
- 10 Main Atrium
- 11 Frost Planetarium Pre-Function
- 12 Frost Planetarium
- 14 The Vista
- 15 The Dive
- 16 The Deep
- 17 Ocean Gallery
- 18 Science Plaza
- 20 Breakout Rooms
- 21 Conference Suite
- 22 Conference Suite Terrace
- 23 Rooftop Terraces
- 24 Enhanced Experiences
- 26 Getting Here
- 27 Capacity Chart

Make your event the toast of the town at one of the city's most talked about venues—the Phillip and Patricia Frost Museum of Science.

With stunning architecture and sweeping views of Biscayne Bay, your event will take place in one of the most spectacular event spaces in South Florida.



Located in Downtown Miami's Maurice A. Ferré Park, Frost Science is a LEED Gold Certified building conveniently located in the heart of the city. The museum offers special experiences and awe-inspiring spaces for corporate, nonprofit and social events, including flexible science exhibition halls, a three-level aquarium, a 250-seat full-dome planetarium and a living rooftop.

Equipped with advanced audiovisual and production capabilities, Frost Science offers dramatic indoor and outdoor event spaces that can accommodate both small gatherings or an elaborate production for 5,000 of your closest friends.

Let our culinary partners create a special custom menu for your event featuring globally-inspired dishes that tempt the palate with visually stunning presentations and exotic flavors.

And don't worry, you're in the best of hands—we have events down to a science!

Museum Buyout

Picture it: you and a lovely group of fellow partygoers exploring and discovering the entire museum at your own pace. As soon as each guest arrives, they'll know that the experience of a lifetime awaits. Your entire party will have exclusive use of all the event spaces and museum exhibitions.

CAPACITY	SQUARE FEET	LOCATION
2,500	250,000	Aquarium, Frost Planetarium, North & West Wing

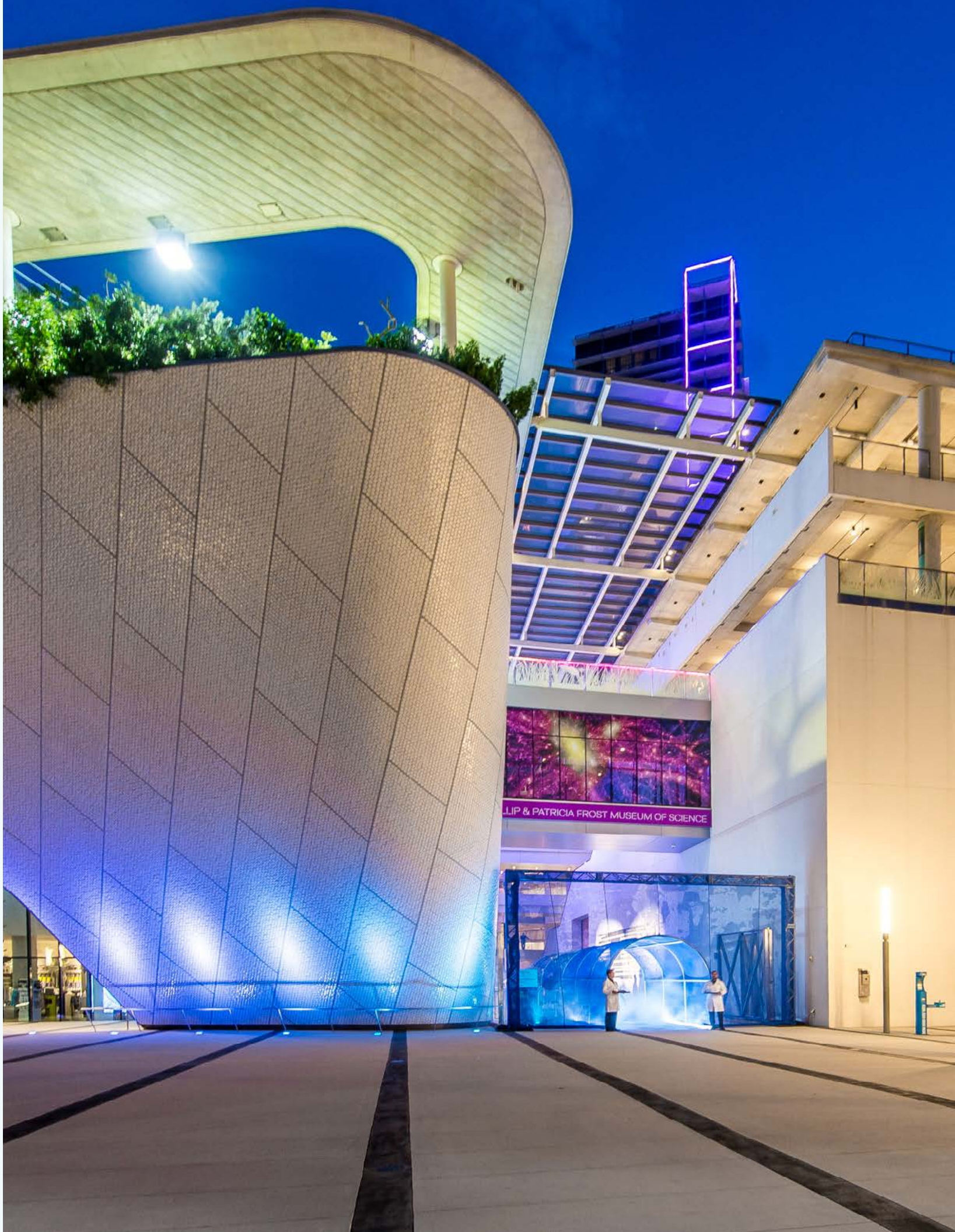
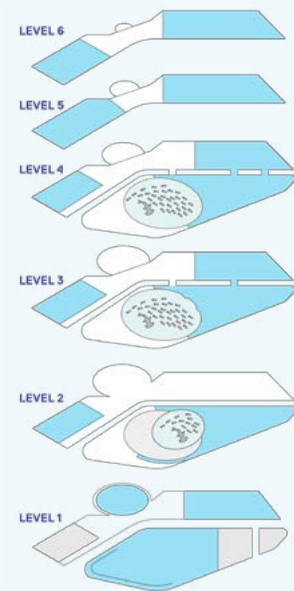

Aquarium Buyout

A masterpiece of living science, the four-level Aquarium invites guests to immerse themselves in the stunning aquatic ecosystems of South Florida and is unlike anything you'll encounter throughout the Magic City.

CAPACITY	SQUARE FEET
1,000	The Vista, Level 4: 8,200
	The Dive, Level 3: 7,000
	The Deep, Level 2 Mezzanine: 3,800
	Ocean Gallery, Level 1: 8,000

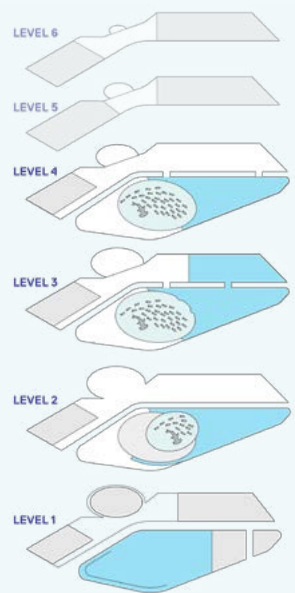

Main Atrium

When arriving at Frost Science, you will enter through the museum’s Main Atrium. The Main Atrium is a unique elongated space, perfect for hosting your next cocktail party or reception. An outdoor but covered space, the Main Atrium is also home to the signature donor wall, showcasing the generous supporters of Frost Science. The Main Atrium is an ideal space to introduce your guests to Frost Science.

CAPACITY	SQUARE FEET	LOCATION
400	8,590	Level 1

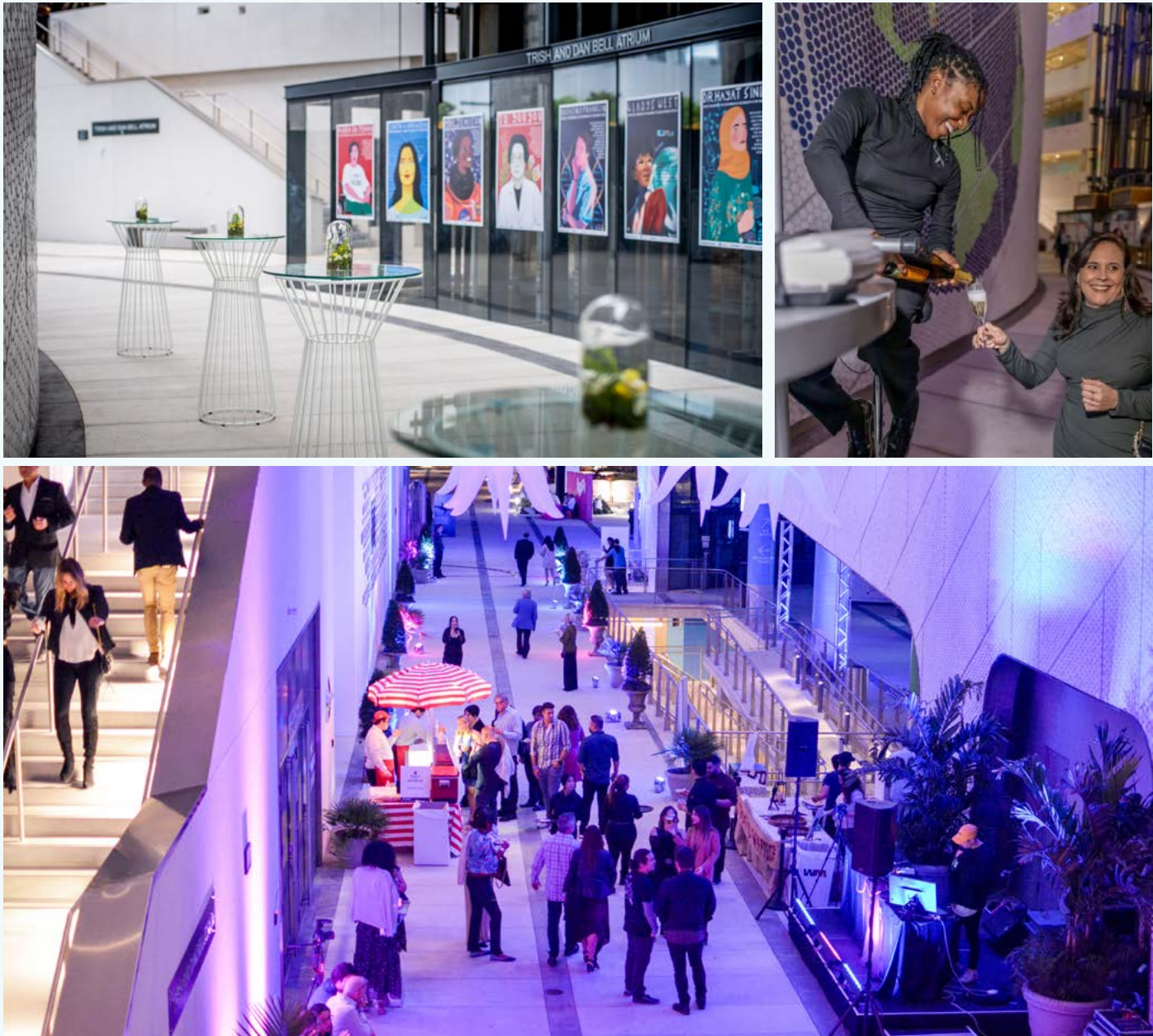

Frost Planetarium Pre-Function

Looking to provide some tantalizing pre- or post-show libations? The Frost Planetarium pre-function reception area offers a unique setting for a dinner or cocktail party, with a customizable LED screen and a canopy of stars.

CAPACITY	SQUARE FEET	LOCATION
70	1,450	Level 1



Frost Planetarium

The Frost Planetarium uses 16-million-color 8K projection, surround sound and a vast dome screen to turn your private presentation, movie screening or lecture into a visual joyride that can both thrill and educate. The space is also visually flexible to meet the demands of any event—it can be customized with your logo, unique brand colors and even a special soundtrack for a custom laser show.

CAPACITY	LOCATION
250	Level 1

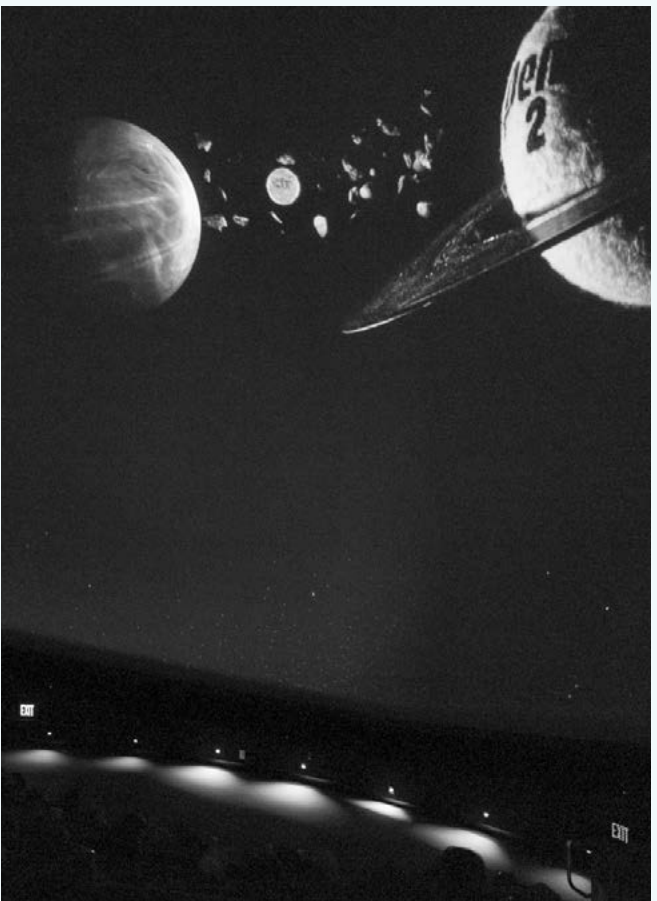
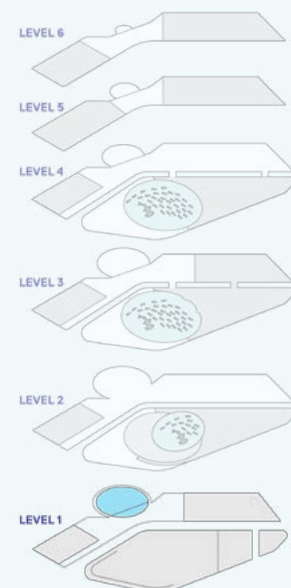

The Vista

Start your event on the massive outdoor covered deck of The Vista with spectacular views of Maurice A. Ferré Park, the Port of Miami and the Downtown Miami skyline. Here, you can marvel at mahi-mahi and scalloped hammerhead sharks as they cruise the waters of the 500,000-gallon Gulf Stream Aquarium. Take a stroll through the aviary and spot some of the green herons currently being rehabilitated or meet our stingrays as they swim in an easy-to-reach pool that allows guests to get hands-on with this cool cartilaginous creature.

CAPACITY	SQUARE FEET	LOCATION
250	8,200	Level 4



The Dive

Descend to The Dive level where your guests will enjoy creative cocktails with stunning underwater views of nearly 30 aquariums and interactive vessels. This unique setting offers a refined yet relaxed atmosphere, where a serene aquatic blue glow emanates from the many aquariums and vibrant displays, creating an enchanting ambiance.

CAPACITY	SQUARE FEET	LOCATION
200	7,000	Level 3

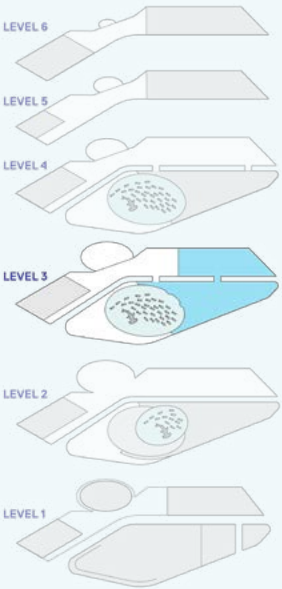
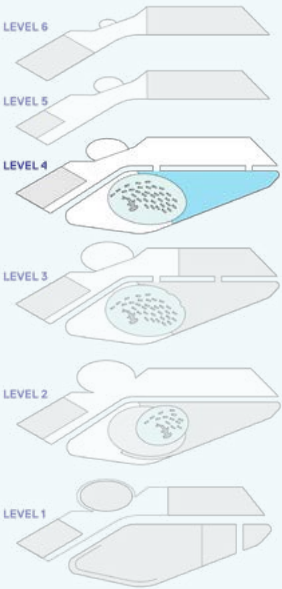

The Deep

With a revealing look at the mysterious and vast depths of the Gulf Stream, the lowest level of the aquarium features a one-of-a-kind, 31-foot-wide oculus lens that forms the bottom of the Gulf Stream Aquarium. Here, you can mix, mingle, or dine as scalloped hammerhead sharks and devil rays swim serenely overhead in an underwater wonderland.

CAPACITY	SQUARE FEET	LOCATION
150	3,800	Level 2

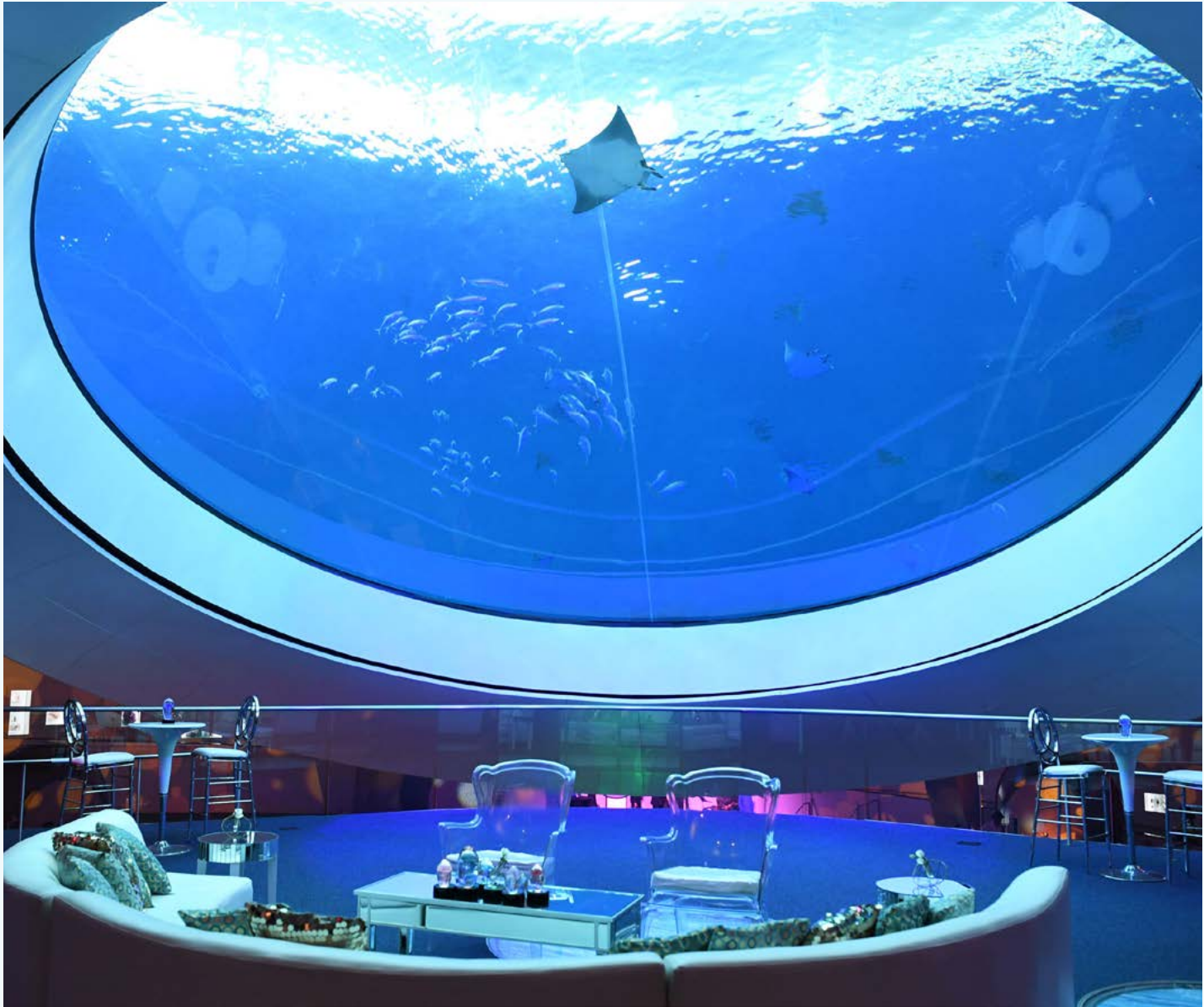
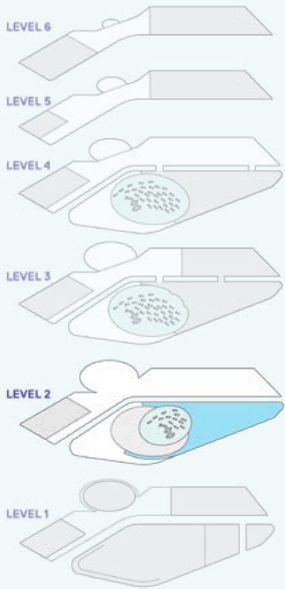

Ocean Gallery

The future of the event landscape is here, and it's all captured within the Ocean Gallery. As the floor exhibits are removed to create an open, flexible area for your cocktail, dinner reception, or presentation, the expansive space is designed to adapt to your vision. Ascend a dramatic and sweeping ramp along gallery walls and dance the night away on the interactive LED dance floor. The massive wall-mounted LED screen can be programmed to screen your media—whether it's a corporate presentation, branded material or live feeds from the stage and the rest of the party.

CAPACITY	SQUARE FEET	LOCATION
400	8,000	Level 1

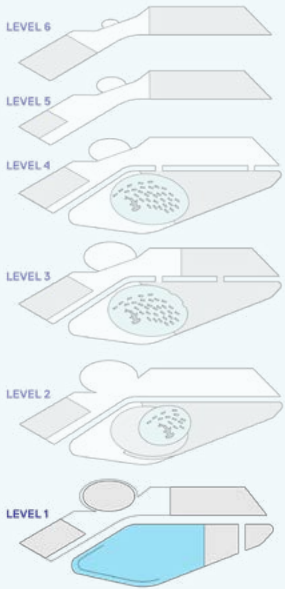

Science Plaza

Bright skies, blue seas and science set the scene on the stunning expanse of the Science Plaza. This easily accessible outdoor space can accommodate large events or be modified with a tent to create a more elegant event space. With ample room for staging, seating, and more, the plaza provides a welcoming atmosphere, ensuring that your guests enjoy a comfortable and memorable experience in this stunning outdoor setting.

CAPACITY	SQUARE FEET	LOCATION
1,200	21,000	Level 1

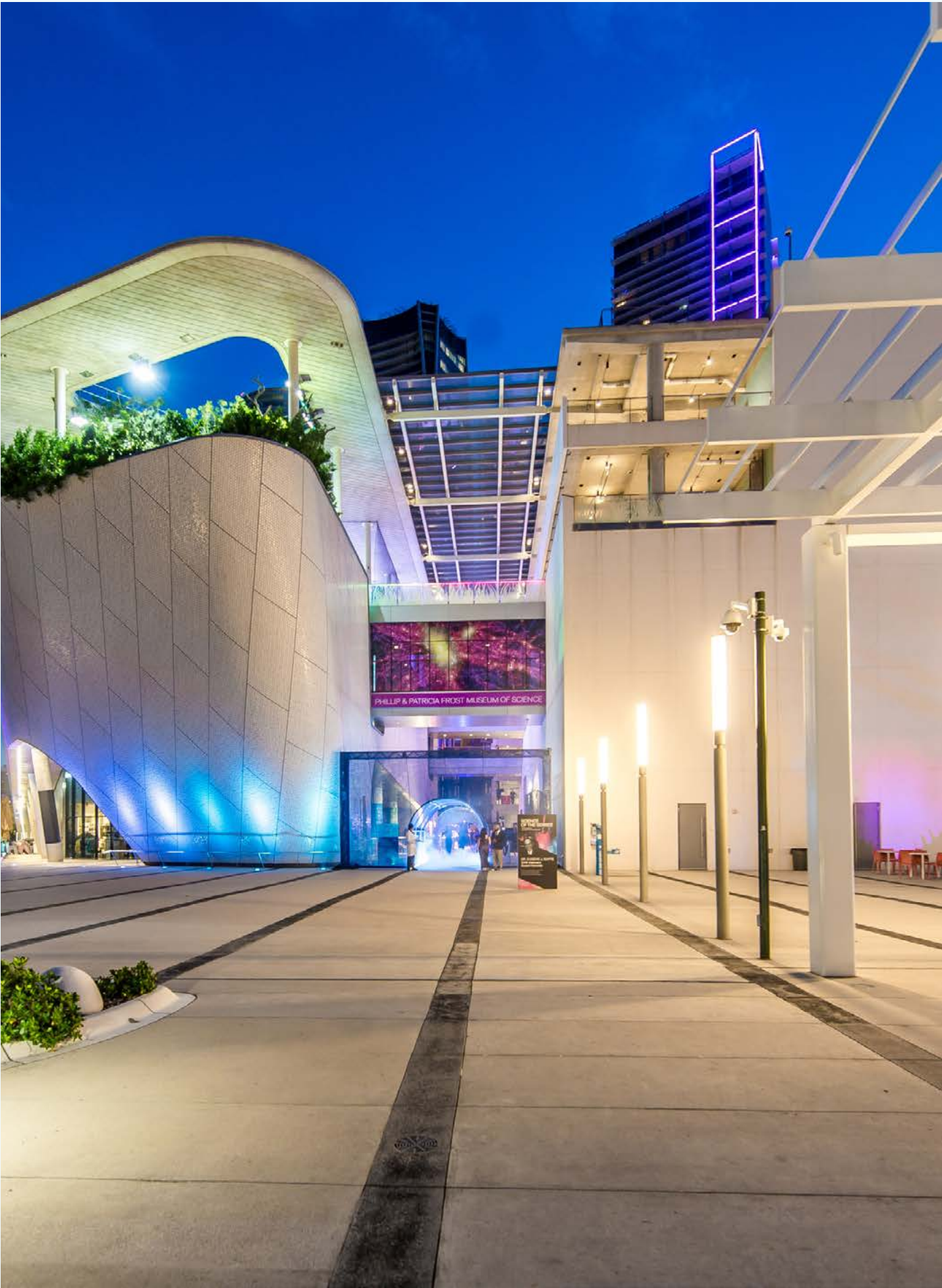
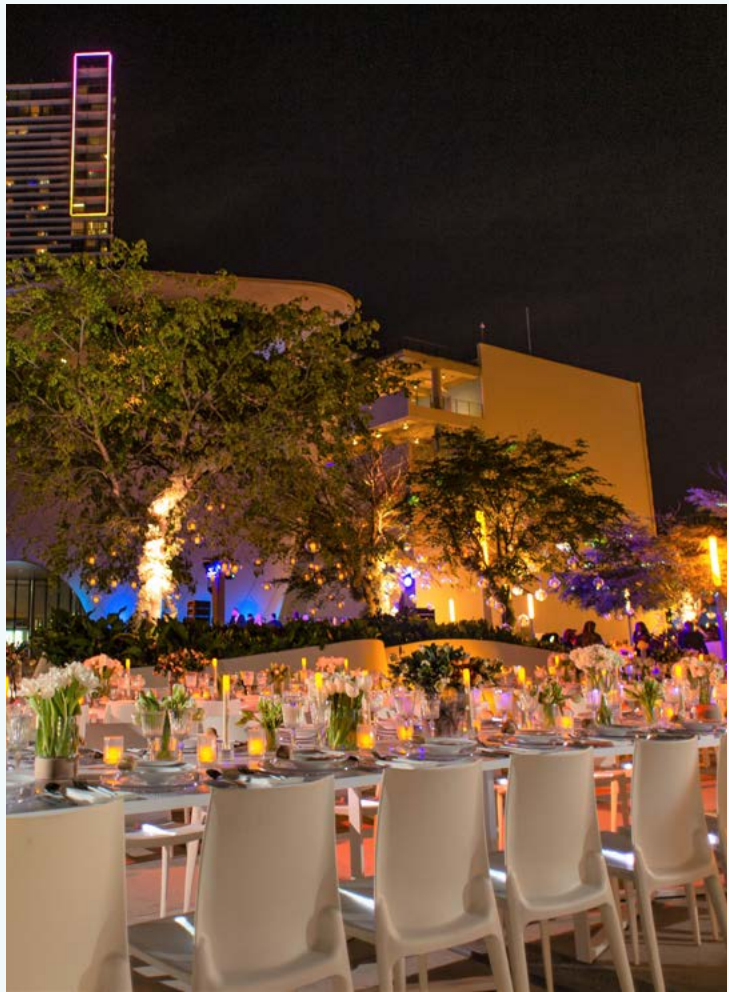
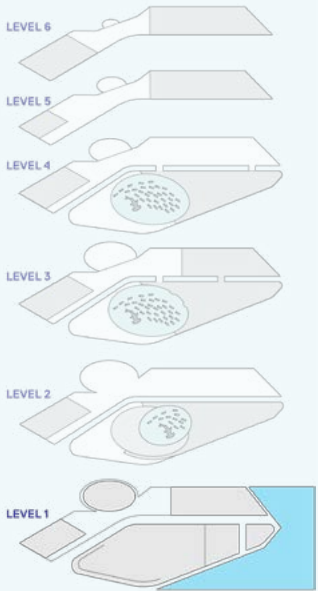

Breakout Rooms

The versatile Knight Learning Center offers three conference rooms with natural light and professional AV capabilities, along with a large picnic terrace that features stunning water views. The adjacent picnic area offers a refreshing al fresco space for breaks, meals and open-air presentations or discussion. Located on the secluded and quiet Level 5, you have the option of booking each classroom separately or combining two of the breakout rooms for larger group gatherings or meetings.

CAPACITY
3 rooms: 140

SQUARE FEET
3,093

LOCATION
Level 5

CAPACITY
Terrace: 250

SQUARE FEET
2,170



Conference Suite

At Frost Science, we know how to get down to business- with style. The Trish and Dan Bell Conference Suite and Terrace – the largest of our corporate spaces- can function as a single large boardroom or can be divided in two separate workspaces using a foldable acoustic partition. With full AV capabilities, this space is ideal for virtual meetings, presentations, or small conferences.

CAPACITY
90

SQUARE FEET
1,060

LOCATION
Level 5



Conference Suite Terrace

From its covered terrace, gorgeous panoramic views of Maurice A. Ferre Park and Biscayne Bay, the Trish and Dan Bell Conference Suite Terrace on Level 5 of the museum’s West Wing makes the perfect backdrop for you next social gathering or corporate lunch before going back to business for the rest of the day.

CAPACITY	SQUARE FEET	LOCATION
150	1,418	Level 5

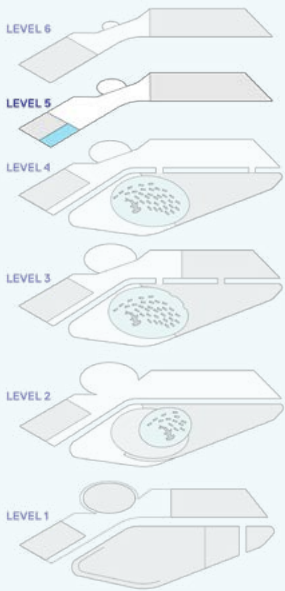

Rooftop Terraces

Discover a showcase of native vegetation and solar wonders on the museum’s living Rooftop Terraces. The lush spaces offer an impressive outdoor environment with panoramic views of Biscayne Bay and Downtown Miami – perfect for cocktail receptions and intimate dinner receptions.

CAPACITY	SQUARE FEET	LOCATION
180	3,255	Level 6

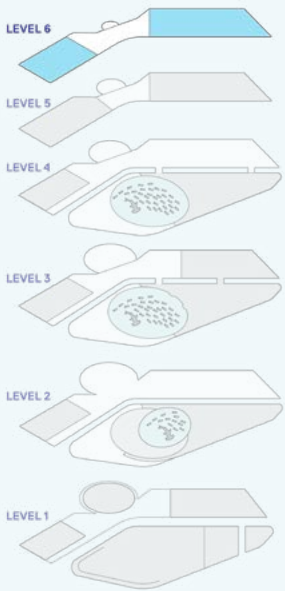

Enhance Your Experience

Sweeten your event with these interactive extras and upgrades:

Team Building Activities: At Frost Science, team building becomes an unforgettable adventure. Guests can embark on an interactive scavenger hunt that takes them through the museum’s stunning exhibitions, encouraging exploration and collaboration. For a more hands-on experience, our expert Education team can customize unique engagement activities—from live science shows to squid dissections and beyond—designed to spark curiosity, teamwork, and a sense of discovery.

Guided Tours: Explore Frost Science like never before with an **Insider’s Tour**. The tour is approximately 60 minutes and highlights some of the museum’s most popular spaces. The fact-filled tour includes insights into the building’s innovative architecture and a behind-the-scenes look at the aquarium life support system. Also, get up-close to our animal residents with special access to a feeding and encounter.

Guest Speaker: Participate in a “TED-style” presentation with one of our knowledgeable scientists and staff members on topics ranging from astronomy to coral reefs.

Private Laser Show: Impress your guests with a rockin’ retro throwback to the classic laser light spectacles you know and love. From Beyoncé to the Beatles, we’re fusing music from some of the greatest artists of our time with old-school laser light visuals—all under the Frost Planetarium’s 67-foot dome.

Prepaid Parking: You may arrange to prepay parking for your guests or enhance your event experience with valet service.

Stargazing: Start your event stargazing on the rooftop Observation Deck for a telescope-powered view of the night sky (weather permitting).

Special Gifts: Pamper your guests with a gift that includes one of our most popular items from the Science Store.

Custom gifts available upon request.



Getting Here

Frost Science, located in Downtown Miami’s Maurice A. Ferré Park, is accessible via car or Metromover. Whether you choose to park onsite, in nearby parking lots or opt for public transportation, you’ll find plenty of options that suit your event’s needs. For a full list of parking and transportation options, visit frostsscience.org/parking.

Onsite Parking

Limited paid self-parking is available in the museum garage.

Public Parking

Street parking and lots are available around Maurice â, Ferré Park. Please visit our website for detailed information.

Public Transportation

Frost Science is directly adjacent to the Miami-Dade Metromover, Museum Park station. Take the Omni loop train to Museum Park and arrive steps from the museum’s entrance.

Valet Parking

Enhance your event experience with valet service. Well-trained and courteous valet attendants will make each guest feel like a VIP during their arrival and departure process. Contact your event manager for a custom quote.



Capacity Chart

MEETING ROOM	FLOOR	SQ.FEET	THEATER	BANQUET	CLASSROOM	RECEPTION
Science Plaza	1	8,275		410		600
Museum Plaza	1	21,000				1,200
Frost Planetarium Pre-show	1	1,450	80	70		150
Frost Planetarium	1		250			
Food@Science	1	1,400	60	50		70
Food@Science Patio	1	2,000		100		200
Ocean Gallery	2	8,000	400	400		600
Aquarium - <i>The Deep</i>	3	3,800		150		300
Aquarium - <i>The Dive</i>	3	7,000		200		400
Feathers to the Stars	3	6,039				180
Aquarium - <i>The Vista</i>	4	8,200		150		700
Trish & Dan Bell - <i>Suite A</i>	5	702	76	50	45	70
Trish & Dan Bell - <i>Suite B</i>	5	380	42	30	36	40
Trish & Dan Bell - <i>Suite AB</i>	5	1,082	100	80	80	90
Trish & Dan Bell - <i>Suite Terrace</i>	5	1,422		80		150
Knight Learning Center Classroom 1	5	780	90	50	35	80
Knight Learning Center Classroom 2	5	960	120	80	50	80
Knight Learning Center Classroom 3	5	1,353	80	100	90	100
Knight Learning Center Classroom 1 & 2	5	1,740	220	130	90	180
Picnic Terrace	5	2,170		120		170
Lunar Terrace	6	2,280		90		150
FPL Solar Terrace	6	975		70		100
Entire Museum						5,000

For more information on how to make
your event the talk of the town, please
contact events@frostscience.org or
call 305-434-9600.

PHILLIP & PATRICIA FROST MUSEUM OF SCIENCE

1101 Biscayne Blvd., Miami, FL 33132 | 305-434-9600

   @FROSTSCIENCE



The Phillip and Patricia Frost Museum of Science is supported by the Miami-Dade County Department of Cultural Affairs and the Cultural Affairs Council, the Miami-Dade County Mayor and Board of County Commissioners of Miami-Dade County. This project is supported by the Building Better Communities Bond Program and the City of Miami. Sponsored in part by the State of Florida, Department of State, Division of Arts and Culture, the Florida Council on Arts and Culture, and the National Endowment for the Arts. The museum is accredited by the American Alliance of Museums, is an affiliate of the Smithsonian Institution and a member of the Association of Science and Technology Centers.